



CLEVELAND HIGH SCHOOL ALUMNI ASSOCIATION

Saturday, August 14, 2004

Cleveland High School



Commons Building from North Courtyard

**CLEVELAND HIGH SCHOOL
PROJECT INFORMATION**

Cleveland High School is changing both in the way it delivers education and the facilities where education is taking place.

In June 2005, Cleveland will start a two-year construction project which will renovate the historical landmark 1927 building (the original school), add a new three-story classroom building, and a new gymnasium and commons facility.

When Cleveland reopens in September 2007, eighty years after it first opened, it will serve 1,000 students and accommodate the small schools that the staff and administration have instituted over this past year. The 1927 building will be historically renovated along with interior modernization that includes elevators, renovated auditorium, classrooms with new lighting and wiring to support computer systems, and updated life safety systems.

The Cleveland school site will include a new parking lot and walkways that connect the buildings and outdoor courtyard areas.

New mechanical heating, air conditioning and ventilation systems will be installed along with new electrical power to meet the needs of modern education. The 1927 building will retain its historical landmark significance on the site while the new structures will accommodate the necessary education spaces that will support high quality education long into this century.

This project is funded through Seattle School District's Building Excellence II program.



Commons and Server



Classroom in Historic Building



West Elevation

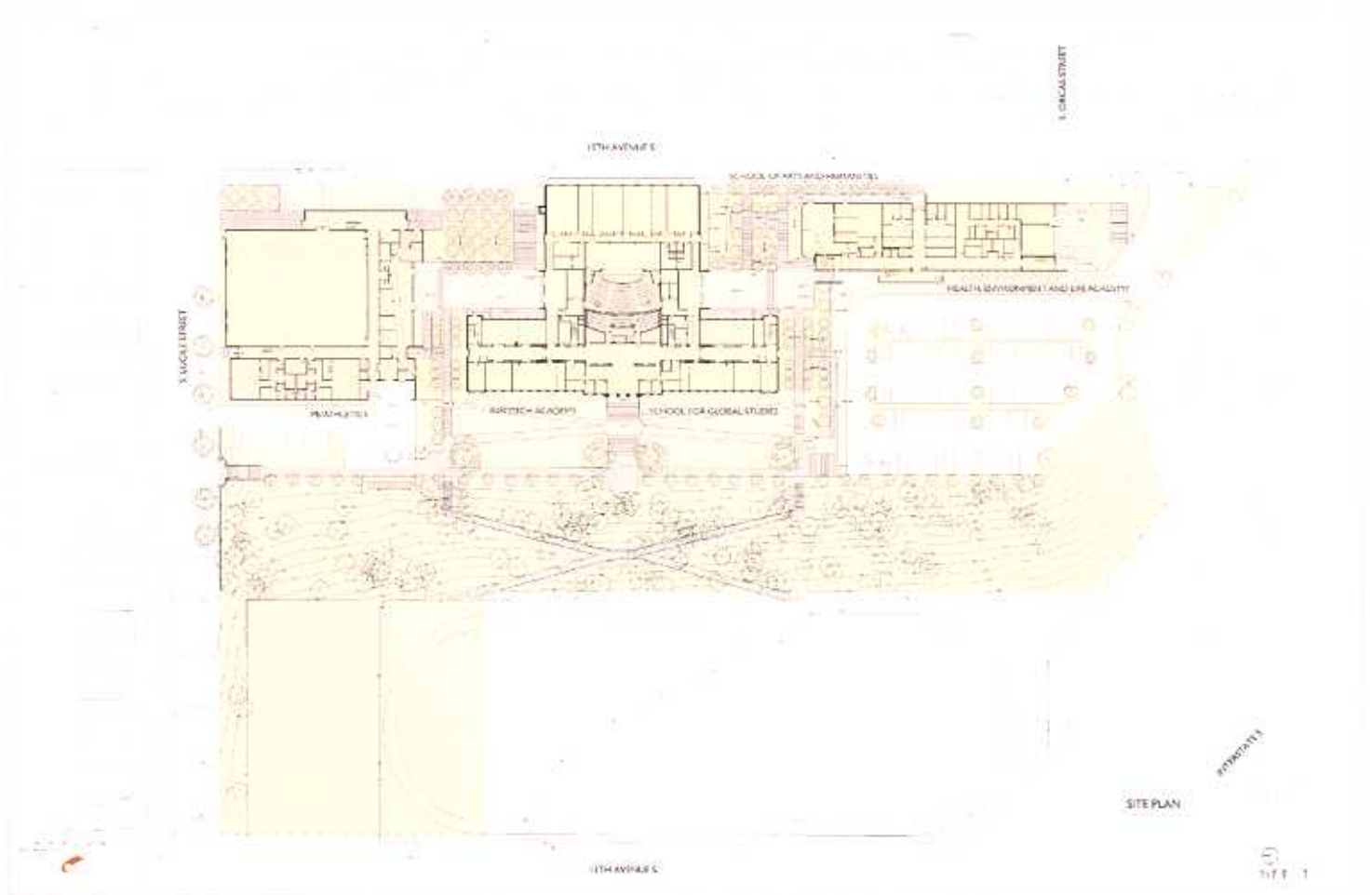

Site Plan

PROJECT CONTACT INFORMATION

Seattle School District: *Gary Baldasari, AIA, Building Excellence II (BEX II) Program Manager, (206) 252-0648*

Cleveland High School Design Team Chairman: *Rick Harwood, Cleveland High School Principal, (206) 252-7800*

Project Manager: *David Wilson, RA, Heery International Inc., (206) 587-0473*

Project Architect: *Butch Reifert, AIA, Principal-in-Charge, Mahlum Architects, (206) 441-4151*

General Contractor Construction Manager: *Rich Teddy, Project Construction Manager, Absher Construction, (253) 845-9544*



INFORMATION ON THIS PROJECT CAN BE FOUND ON THE SEATTLE SCHOOL DISTRICT WEBSITE:
www.seattleschools.org/area/facilities/SchoolProjects/ClevelandLink.xml



New Classroom Building and South Courtyard